

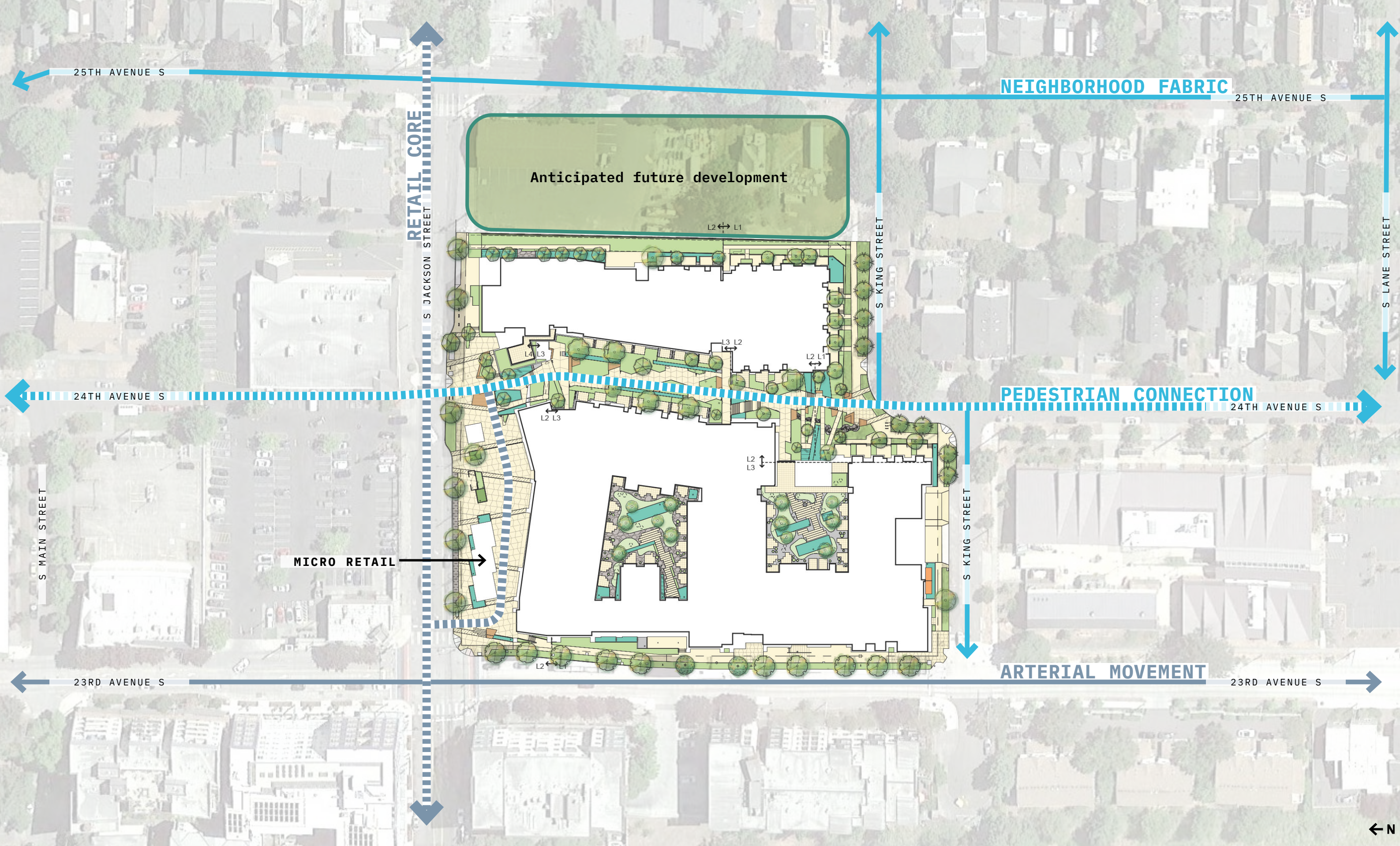

A renewed connection is the vibrant heart for an eclectic neighborhood. 24th Avenue, unplatted in a previous commercial development, is rejuvenated as a vital corridor and link for pedestrians and pollinators.



The junction of a transitioning neighborhood embracing the dynamic forces imposed by the existing neighborhood, the restored pedestrian connection, culminates in a plaza activated daily by micro-retail spaces and designed to host markets and other community events.



Distributed across the site to mitigate stormwater runoff, bioretention planters respond to the community's call for the project 'breathe green'. Close coordination of roof to planter area and routing in between results in a celebration of the movement of water.

FRACTALS

A fractal is a natural phenomenon that exhibits a repeating pattern that displays at every scale known as evolving symmetry and are seen extensively throughout nature.



Fractals are also embedded in African architecture, textiles, art, and religion, even music.

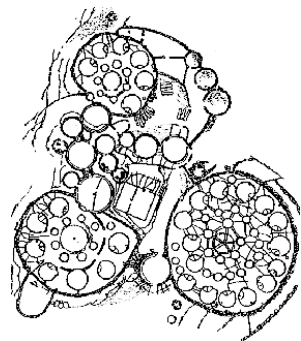

MOKULEK VILLAGE

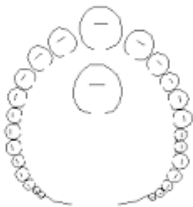

FRACTAL MODEL FOR BA-VILLAGE



THREE WOMEN, PICASSO, 1980

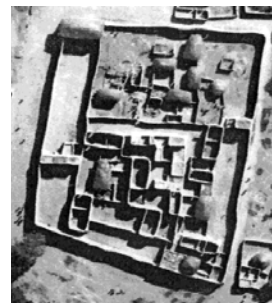

LOGONE-BIRINI CAMEROON



AFRICAN WEDDING BLANKET

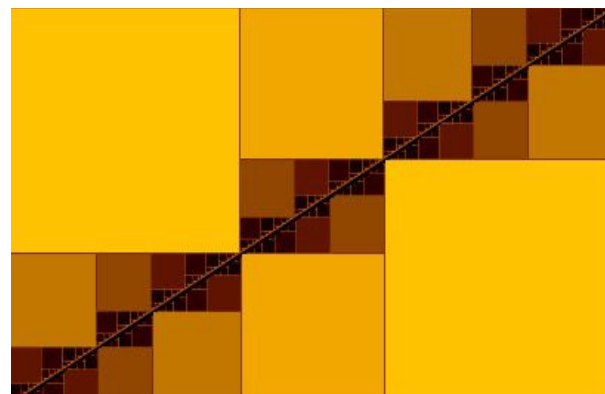

FRACTAL PATTERS, MONTESSORI



TEXTURE IN AFRICAN CRAFTSMANSHIP

PATTERN

With fractals as a point of inspiration, how can we create a form language across the site that is rich, layered, rhythmic and scalable?

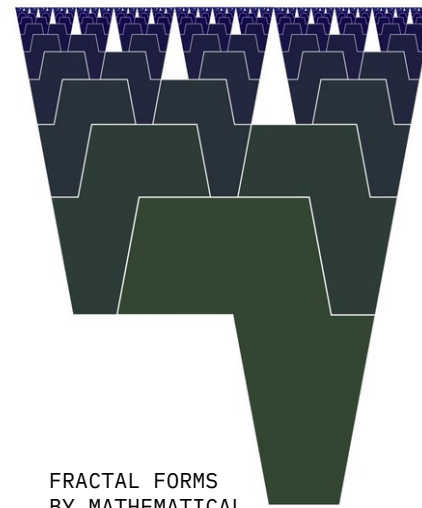

FRACTAL FORMS BY MATHEMATICAL ARTIST, HAMID YEGANEH

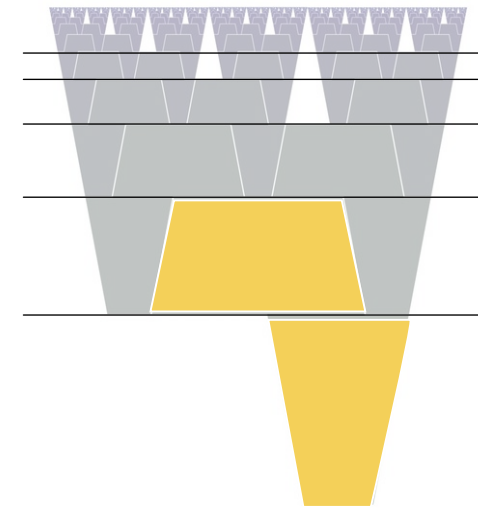

BREAK DOWN INTO TWO SIMPLE FORMS THAT CAN REPEAT AT DIFFERENT SCALES

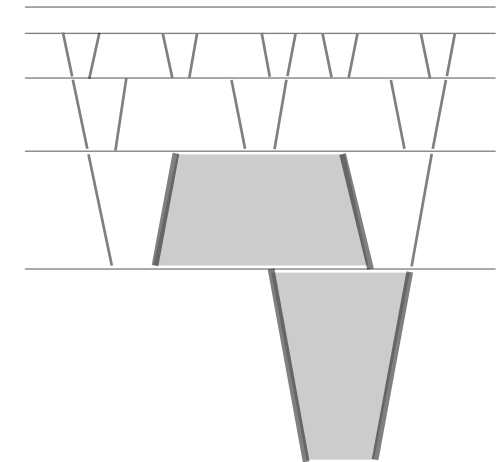

AND REPEATING ANGLES THAT CREATE A RHYTHM ACROSS THE SITE



Working with community members to respect the local African American Community heritage without appropriation in the project design, the legacy of fractals that unite broad swaths of African culture across architecture and art was identified as rich with opportunity.



The tapestry-informed fractal design language sews together building and site. Architectural skin and barrier rails announce the language vertically, while the paving brings it into the groundplane at multiple scales and extruding the language at the seating plinths.



Shaped by rhythm and repeating patterns, this new pedestrian link graciously accommodates the public, while using layered habitat and stormwater absorbing planting to give comfort and context to the private spaces fronting this dynamic place.



Having a place to sit and be seen, to stoop sit, emerged as a project requirement from conversations with community residents who saw it both as recalling neighborhood history and fostering continued community social connections.



At human scale, the movement of water is overt on sunny days. Artwork is placed to draw you through. Platforms of wood and artificial turf allow for spilling out and lingering, listening to the quiet buzz of the pollinators.



The focal point as the midblock plaza transitions to a south-facing neighborhood stairclimb, *Winds of Change: We Are Still Here*, by Marita Dingus and Preston Hampton whose billowing silhouette belies the challenges of living in a changing community.



The neighborhood termination of the midblock welcomes the full multi-generational spectrum, with plentiful seating, low sloping walkways as well as a playful boulder hill climb in combination with stairs to welcome all.

BREATHE GREEN

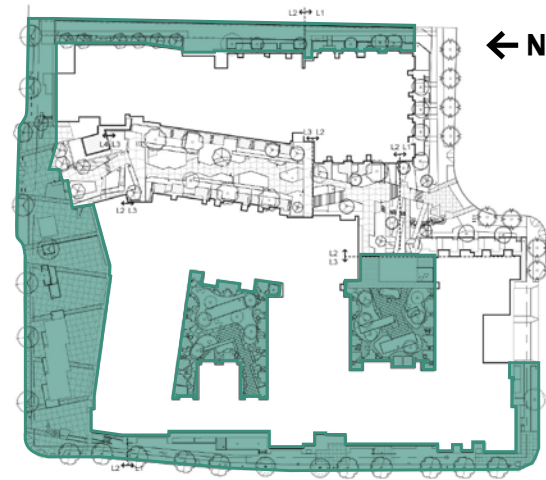

FOR THE BIRDS (AND THE BEES)

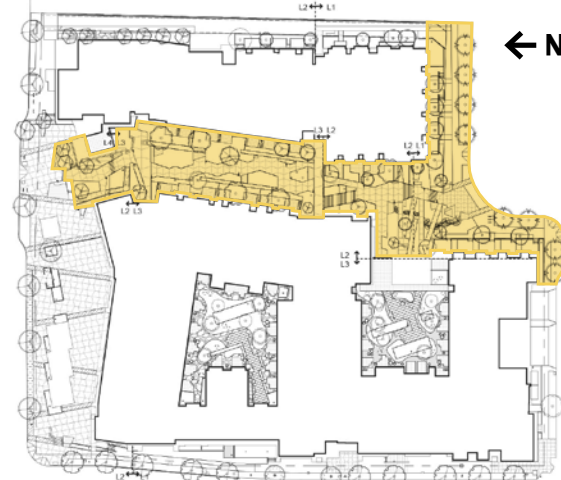

BREATHE BLUE

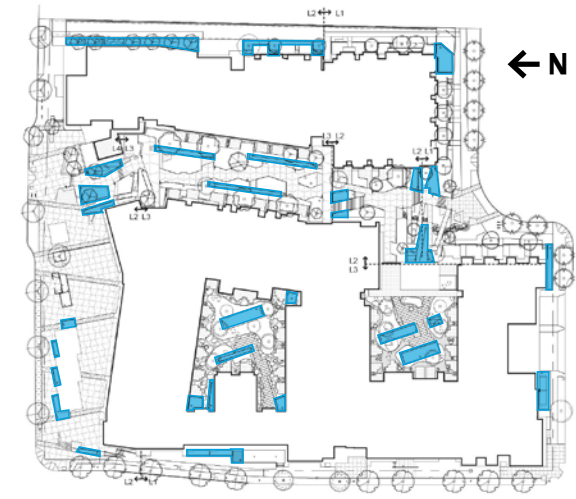

MAHONIA NERVOSA
DWARF OREGON GRAPE



ANEMONE X 'HONORINE JOBERT'
JAPANESE ANEMONE



ARCTOSTAPHYLUS MANZANITA
'AUSTIN GRIFFITHS'



SORBUS AUCUPARIA
'CARDINAL ROYAL'



IRIS TENAX
TOUGH LEAF IRIS



LIGULARIA
'LITTLE ROCKET'



LONICERA PILEATA
PRIVET HONEYSUCKLE



VIBURNUM DAVIDII
DAVID VIBURNUM



ECHINACEA PURPUREA
PURPLE CONEFLOWER



PERSICARIA
AMPLEXICAULIS 'ROSEA'



JUNCUS PATENS
'ELK'S BLUE'



CAREX OBNUPTA
SLOUGH SEDGE



NEPETA RACEMOSA
'WALKER'S LOW'



LIASTRIS
'BLAZING STAR'

Crafting the plant palette for overt performance was a critical part of welcoming the community into the site and providing varied activation providing seasonal interest while providing for the year-round needs of birds and other pollinators.



Breathing Green starts with a sense of urban oasis, lush textures punctuated by a rotating program of colors, while the movement of water in our rainy climate is celebrated by burbling runnels that frame moments and subdivide the space.



Blending evergreen structure with soft and textural grasses that change across the seasons, this structure supports a diverse overlay of food sources (pollen, nectar, seeds and nuts) dispensed throughout the year to attract diverse wildlife.



The distributed bioretention system, hosted in maroon planters, pervades the site as a buffering element between private residences and public space. The sense of separation they provide makes the midblock and courtyard spaces comfortable for both types of users.



A welcoming and open community connection through the evening hours. Lit to balance the needs of the public with the needs of the residents, while minimizing uplight to respect the dark sky's role in supporting wildlife in urban landscapes.